

# Accessories

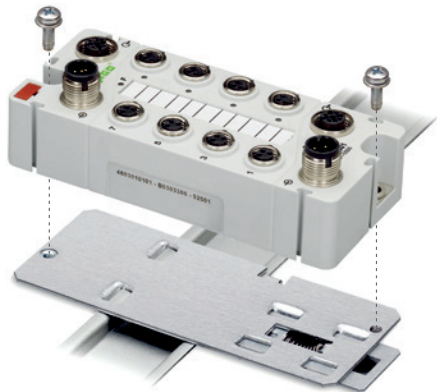

Carrier rail adapter		
	Item No.	Pack. Unit
Carrier rail adapter, for couplers/progr. couplers	767-121	1
Carrier rail adapter, for I/O and power distribution modules	767-122	1
Carrier rail adapter, for I/O module 8 x M12	767-125	1

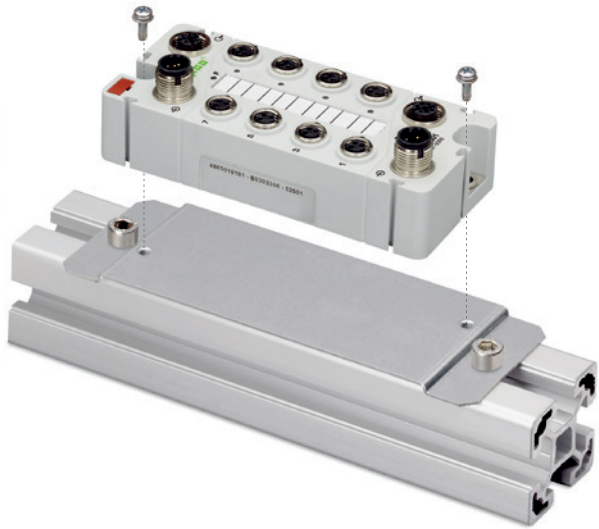

Profile adapter		
	Item No.	Pack. Unit
Profile adapter, for couplers/progr. couplers	767-123	1
Profile adapter, for I/O and power distribution modules	767-124	1
Profile adapter, for I/O module 8 x M12	767-126	1

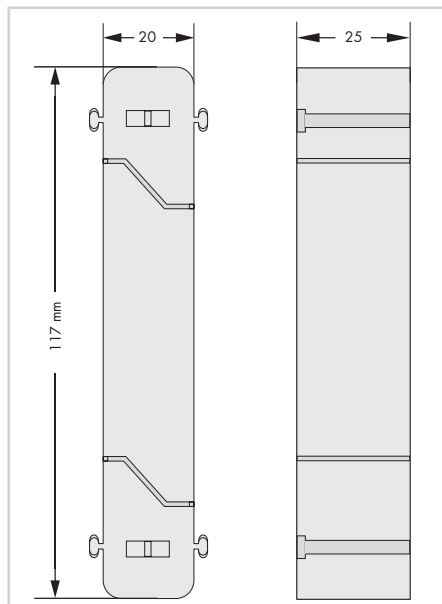
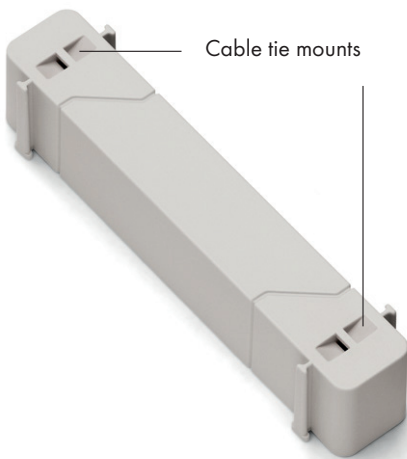

Spacer module		
	Item No.	Pack. Unit
	767-111	1

## Accessories

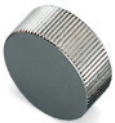

Marking strip		
	Item No.	Pack. Unit
Marking strip, 8xM8	767-101	100
Marking strip, 4xM12	767-102	100
Marking strip, for power distribution modules	767-103	100
Marking strip, 8 x M12	767-104	100
Marking strip, 9.9 mm wide, 50 m roll	757-901/000-050	1

Marking pen		
	Item No.	Pack. Unit
for permanent marking	210-110	1

Protective caps (for unused sockets)		
	Item No.	Pack. Unit
M8 protective cap	756-8101	10
M12 protective cap	756-8102	10

Protective caps (for unused plugs)		
	Item No.	Pack. Unit
M12 protective cap	756-8103	1

Protective caps (for unused plugs)		
	Item No.	Pack. Unit
M23 protective cap	756-8104	1

Locking clip (protects pre-assembled connectors from tool-free disconnection)		
	Item No.	Pack. Unit
Locking clip, M8	756-8301	10
Locking clip, M12	756-8302	10

# Configurable shielded connectors



Conductor size  
 Ø 6 ... 8 mm  
 screw clamp connection:  
 0.14 ... 0.75 mm<sup>2</sup>  
 spring clamp connection:  
 0.14 ... 0.5 mm<sup>2</sup>

M12 plug, straight		Item No.	Pack. Unit
Fitted pluggable connector, 5-pole shielded, M12 plug, straight A coded, Spring		756-9207/060-000	1
Fitted pluggable connector, 5-pole shielded, M12 plug, straight B coded, Spring		756-9401/060-000	1
Fitted pluggable connector, 5-pole shielded, M12 plug, straight B coded, Screw		756-9411/060-000	1
Fitted pluggable connector, 4-pole shielded, M12 plug, straight D coded, Spring		756-9501/060-000	1



Conductor size  
 Ø 6 ... 8 mm  
 screw clamp connection:  
 0.14 ... 0.75 mm<sup>2</sup>  
 spring clamp connection:  
 0.14 ... 0.5 mm<sup>2</sup>

M12 plug, right angle		Item No.	Pack. Unit
Fitted pluggable connector, 5-pole shielded, M12 plug, right angle A coded, Spring		756-9211/060-000	1
Fitted pluggable connector, 5-pole shielded, M12 plug, right angle B coded, Spring		756-9403/060-000	1
Fitted pluggable connector, 5-pole shielded, M12 plug, right angle B coded, Screw		756-9413/060-000	1
Fitted pluggable connector, 4-pole shielded, M12 plug, right angle D coded, Spring		756-9501/040-000	1



Conductor size  
 Ø 6 ... 8 mm  
 screw clamp connection:  
 0.14 ... 0.75 mm<sup>2</sup>  
 spring clamp connection:  
 0.14 ... 0.5 mm<sup>2</sup>

M12 socket, straight		Item No.	Pack. Unit
Fitted pluggable connector, 5-pole shielded, M12 socket, straight A coded, Spring		756-9208/060-000	1
Fitted pluggable connector, 5-pole shielded, M12 socket, straight B coded, Spring		756-9402/060-000	1
Fitted pluggable connector, 5-pole shielded, M12 socket, straight B coded, Screw		756-9412/060-000	1



Conductor size  
 Ø 6 ... 8 mm  
 screw clamp connection:  
 0.14 ... 0.75 mm<sup>2</sup>  
 spring clamp connection:  
 0.14 ... 0.5 mm<sup>2</sup>

M12 socket, right angle		Item No.	Pack. Unit
Fitted pluggable connector, 5-pole shielded, M12 socket, right angle A coded, Spring		756-9210/060-000	1
Fitted pluggable connector, 5-pole shielded, M12 socket, right angle B coded, Spring		756-9404/060-000	1
Fitted pluggable connector, 5-pole shielded, M12 socket, right angle B coded, Screw		756-9414/060-000	1



Conductor size  
 Ø 6 ... 8 mm/  
 0.14 ... 0.50 mm<sup>2</sup>

8-pole

M12 socket, straight and right angle		Item No.	Pack. Unit
Fitted pluggable connector, 8-pole shielded, M12 socket, straight, Screw		756-9211/090-000	1
Fitted pluggable connector, 8-pole shielded, M12 socket, right angle, Screw		756-9214/090-000	1

## Configurable connectors with PG9 thread

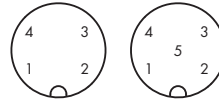
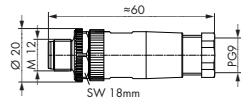

Conductor size  
 Ø 6 ... 8 mm  
 screw clamp connection:  
 0.25 ... 0.75 mm<sup>2</sup>  
 spring clamp connection:  
 0.14 ... 0.5 mm<sup>2</sup>

### M12 plug, straight

Fitted pluggable connector, 4-pole, M12 plug, straight A coded, Screw

Item No.	Pack. Unit
756-9203/040-000	1
756-9203/050-000	1

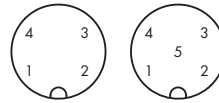
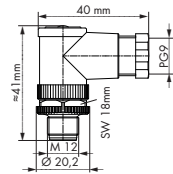

Conductor size  
 Ø 6 ... 8 mm  
 screw clamp connection:  
 0.25 ... 0.75 mm<sup>2</sup>  
 spring clamp connection:  
 0.14 ... 0.5 mm<sup>2</sup>

### M12 plug, right angle

Fitted pluggable connector, 4-pole, M12 plug, right angle A coded, Screw

Item No.	Pack. Unit
756-9206/040-000	1
756-9206/050-000	1

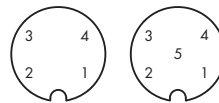
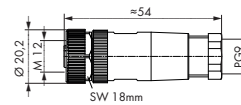

Conductor size  
 Ø 6 ... 8 mm  
 screw clamp connection:  
 0.25 ... 0.75 mm<sup>2</sup>  
 spring clamp connection:  
 0.14 ... 0.5 mm<sup>2</sup>

### M12 socket, straight

Fitted pluggable connector, 4-pole, M12 socket, straight A coded, Screw

Item No.	Pack. Unit
756-9213/040-000	1
756-9213/050-000	1

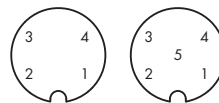
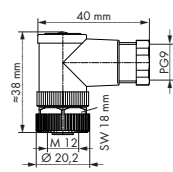

Conductor size  
 Ø 6 ... 8 mm  
 screw clamp connection:  
 0.25 ... 0.75 mm<sup>2</sup>  
 spring clamp connection:  
 0.14 ... 0.5 mm<sup>2</sup>

### M12 socket, right angle

Fitted pluggable connector, 4-pole, M12 socket, right angle A coded, Screw

Item No.	Pack. Unit
756-9216/040-000	1
756-9216/050-000	1

# USB communication cable, terminating resistors, T-piece

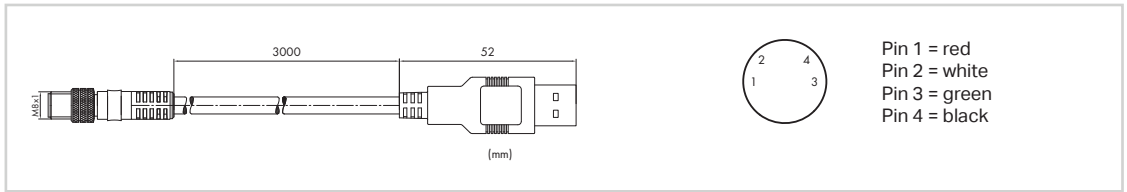

## USB communication cable

	Item No.	Pack. Unit
USB communication cable, M8 plug, straight, USB Typ A plug, straight, 3 m	756-4101/042-030	1



## System bus terminating plug

	Item No.	Pack. Unit
M12 system bus terminating plug, B coded, straight	756-9409/060-000	1

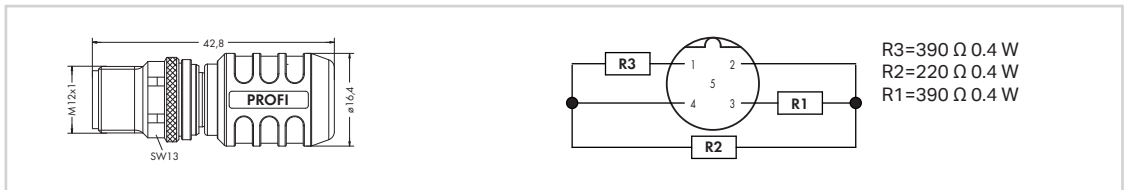

## PROFIBUS terminating plug

	Item No.	Pack. Unit
M12 PROFIBUS terminating plug, B coded, straight	756-9405/060-000	1

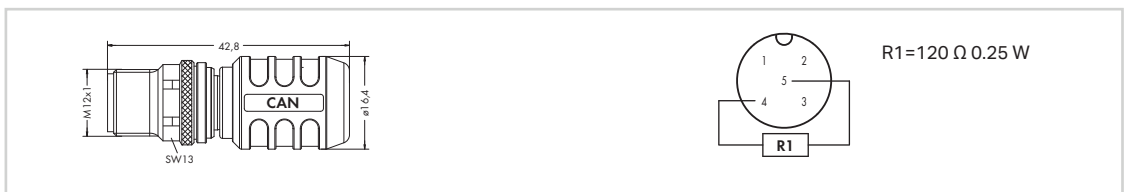

## CANopen, DeviceNet terminating plug

	Item No.	Pack. Unit
M12 CANopen, DeviceNet terminating plug, A coded, straight	756-9209/060-000	1

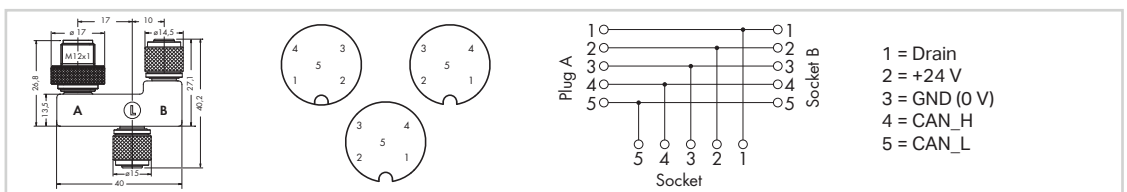

## DeviceNet drop T-piece

	Item No.	Pack. Unit
M12 DeviceNet drop T-piece	756-9303/050-000	1

# ETHERNET, PROFINET accessories

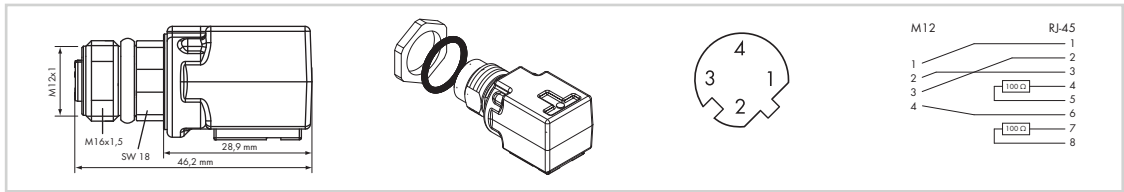

Adapter, right angle, M12 socket, D coded/RJ-45 socket

Adapter, right angle, M12 socket, D coded/RJ-45 socket (also ideally suited for control cabinet feedthrough applications or connecting IP67/IP20 components)

Item No.	Pack. Unit
756-9503/040-000	1

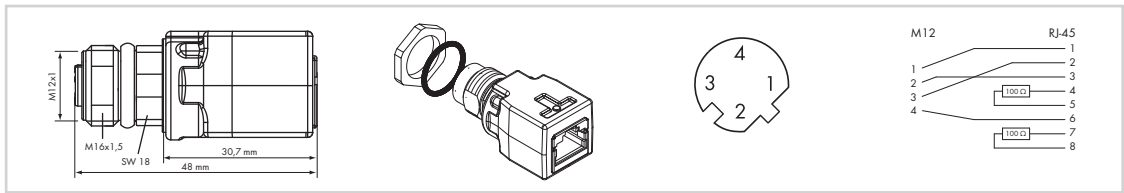

Adapter, straight, M12 socket, D coded/RJ-45 socket

Adapter, straight, M12 socket, D coded/RJ-45 socket (also ideally suited for control cabinet feed-through applications) or connecting IP67/IP20 components)

Item No.	Pack. Unit
756-9504/040-000	1

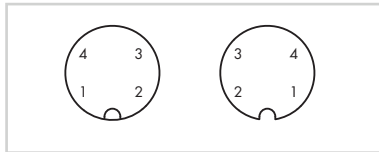

M12 socket / M12 plug, A coded

Item No.	Pack. Unit
M12 panel feed-through connectors, A coded 756-9217/050-000	1

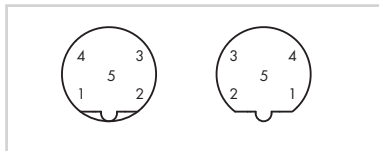

M12 socket / M12 plug, B coded

Item No.	Pack. Unit
M12 panel feed-through connectors, B coded 756-9406/050-000	1

# M12 termination and M23 configurable connectors

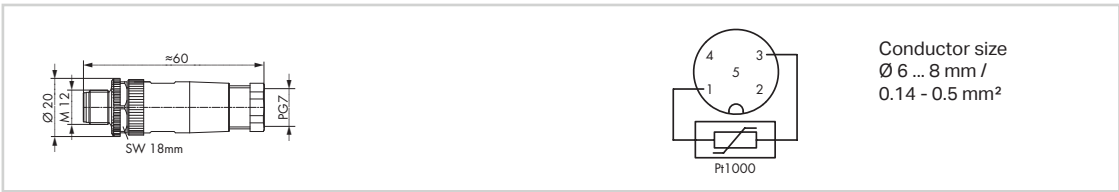

Compensation connector, M12 plug, for 767-6403 Thermocoupler Module (Pt1000 sensor integrated)

	Item No.	Pack. Unit
Compensation connector, M12 plug, straight, 5 poles, spring clamp technology	756-9207/050-000	1

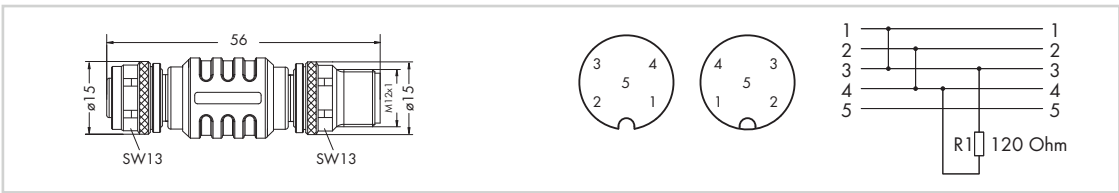

Termination M12

	Item No.	Pack. Unit
RS-422/-485 Termination M12	756-9218/050-000	1

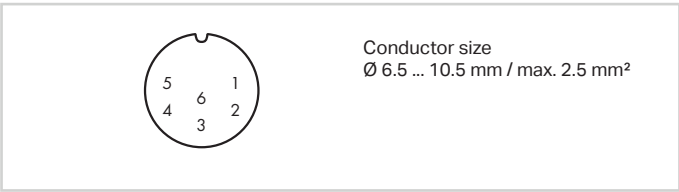

M23 plug

	Item No.	Pack. Unit
Fitted pluggable connector, 6-pole, M23 plug, straight, Solder	756-9601/060-000	1
Fitted pluggable connector, 6-pole, M23 plug, right angle, Solder	756-9602/060-000	1

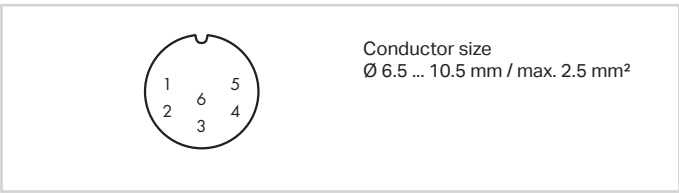

M23 socket

	Item No.	Pack. Unit
Fitted pluggable connector, 6-pole, M23 socket, straight, Solder	756-9603/060-000	1
Fitted pluggable connector, 6-pole, M23 socket, right angle, Solder	756-9604/060-000	1



M23 assembly key

	Item No.	Pack. Unit
M23 assembly key	756-8201	1

## Torque Wrench M8 and M12, Assembly kit



Assembly kit for 756 Series IP67 cable assemblies and pluggable connectors with hex nut, consists of:

- Tool kit
- Torque screwdriver with adjustable torque (window scale)
- Adjustment tool for changing the torque
- Socket wrench SW9 (for M8 cable assemblies)
- Socket wrench SW13 (for M12 cable assemblies)

A torque specification of 0.6 Nm for M8 connectors and 1.0 Nm for M12 connectors is required for 756 Series cables and connectors.

Torque Wrench M8 and M12		
	Item No.	Pack. Unit
	206-701	1

Torque range	0.4 ... 1 Nm $\pm 6\%$
Material	
Handle	Polypropylene (PP) for hard zone, thermoplastic elastomers (TPE) for soft zone
Allen key	Polyamide (PA), fiber-glassreinforced; chromium-vanadiummolybdenum steel (CrMoV) (1.2381)
Adjustment tools	Cellulose acetate; chromiumvanadium-molybdenum steel (CrMoV) (1.2381)
Color	black
Standards/specifications	EN ISO 6789; BS EN 26789; ASME B107.14.M